

SCALE 1 : 750

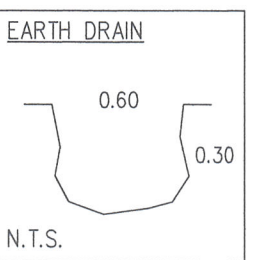
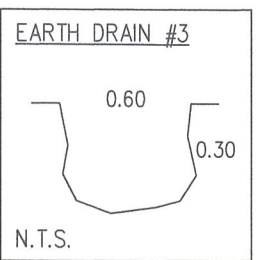
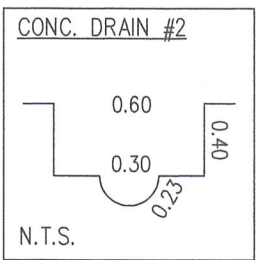
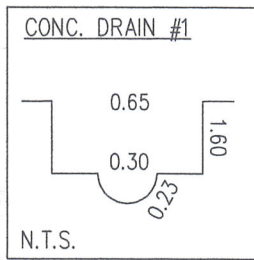
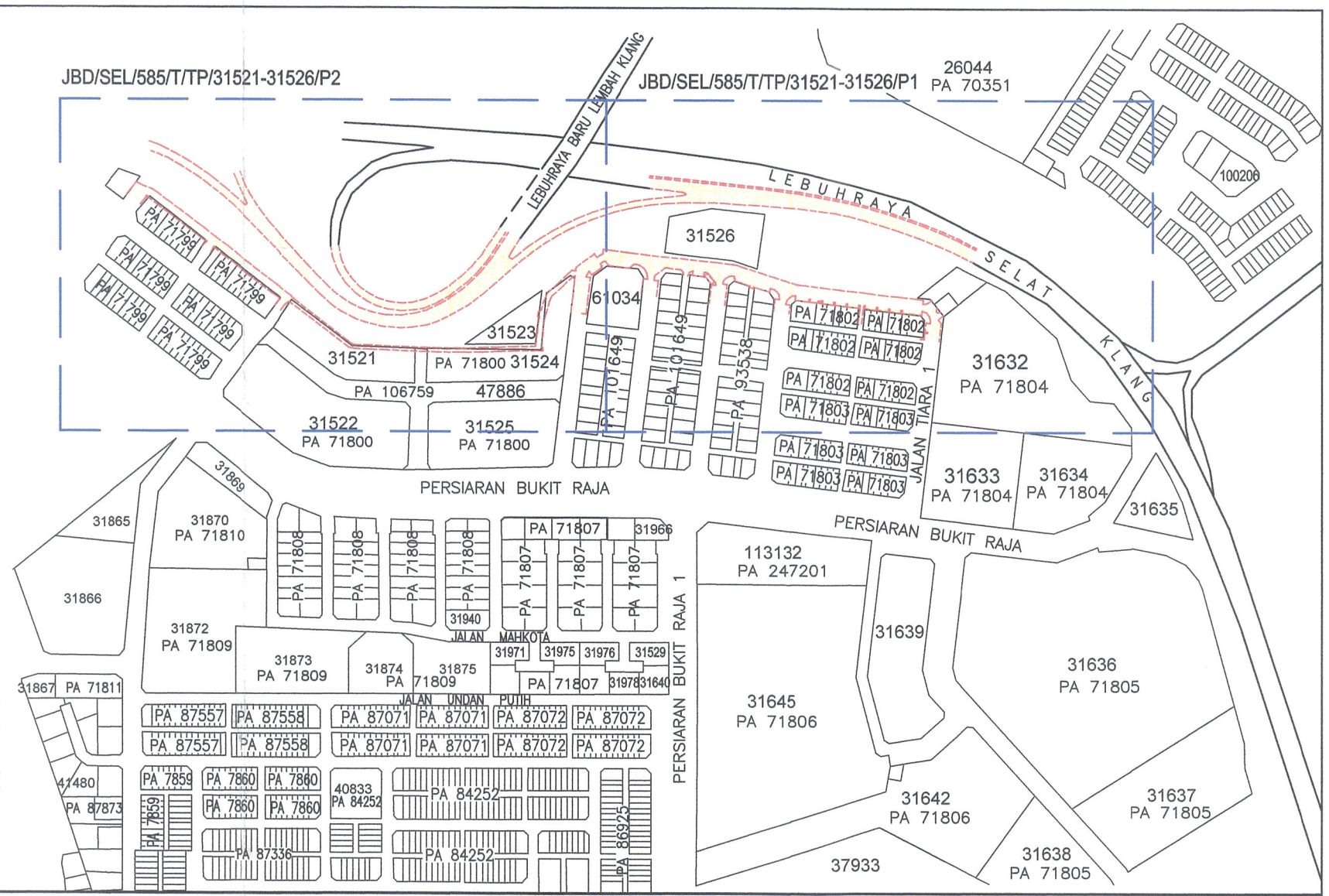
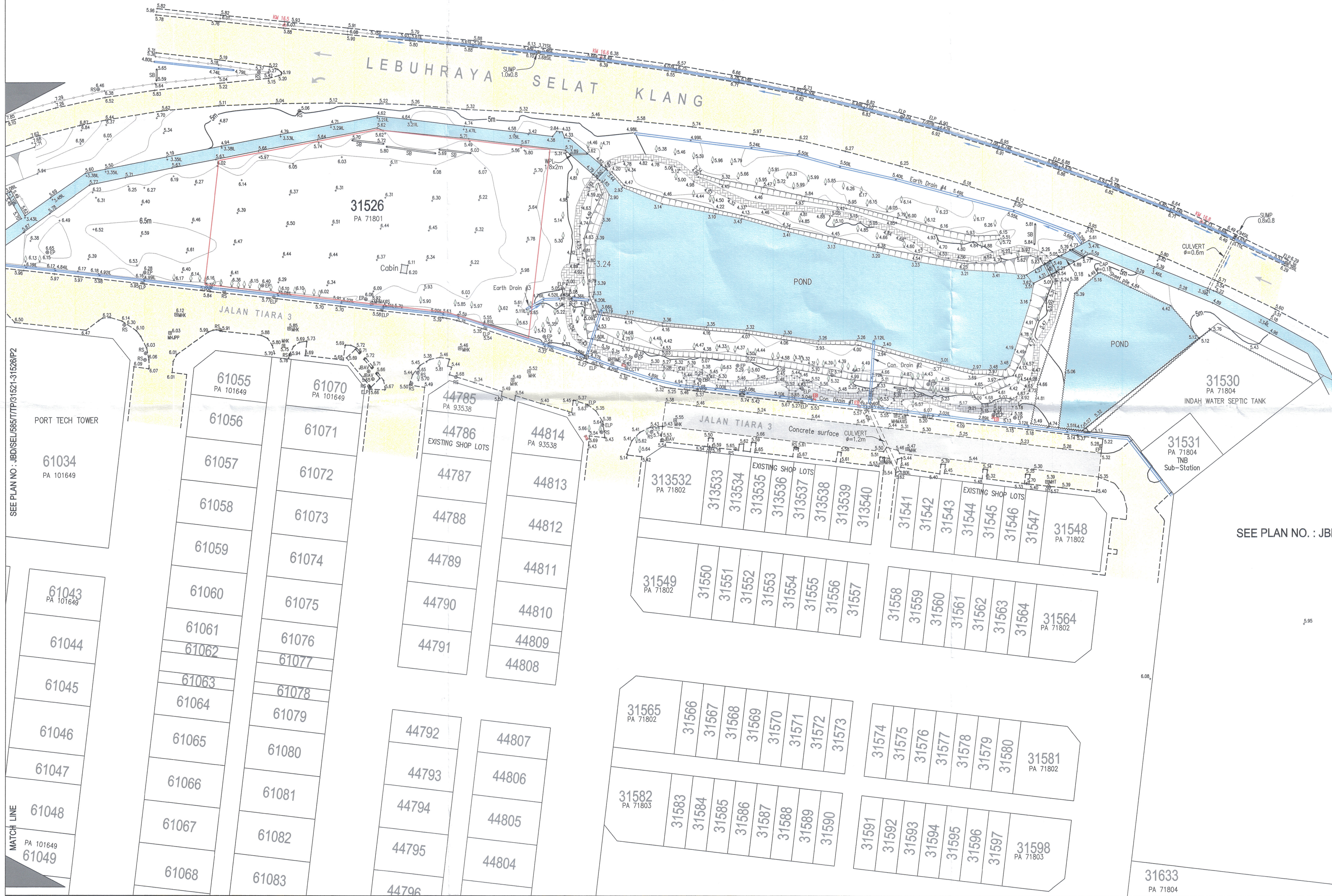

LEGENDS	
SYMBOL	DESCRIPTION
SB	SIGNBOARD
SIL	SUMP INVERT LEVEL
EP	ELECTRIC POST
RS	ROAD SIGN
ELP	ELECTRIC / LAMP POST
LP	LAMP POST
WH	WOODEN HOUSE
WPL	WATER PIPE LINE
MHK	MANHOLE KUMBAHAN
	GUARD RAIL
	ZINC FENCE / SHEET PILE
	CHAIN LINKED FENCE
	CONCRETE / EARTH DRAIN
	FOOTPATH
	METALLED ROAD
	MONSOON DRAIN/POND
	TREE

PLAN TITLE :

DETAIL AND SPOT LEVEL SURVEY ON  
LOT 31521, 31522, 31523, 31524 & 31526  
MUKIM KAPAR, DAERAH KLANG  
SELANGOR DARUL EHSAN

NOTES :

- ALL MEASUREMENT ARE IN METRES.
- SEMUJA ARAS LARAS ADALAH BERDASARKAN BM 80847 (RL : 3.180m) DI KANAN JALAN KAPAR-KLANG. DI HADAPAN STESEN MINYAK PETRONAS. DI KAWASAN TAMAN BUNGA

SURVEYED BY : FOO 12-MAY-21  
DRAWN BY : TEO 20-MAY-21  
CHECKED BY : LOH

JURUKUR TANAH BERLESEN



Sr LOH SOW KAM  
JURUKUR TANAH BERLESEN  
DIBAWAH AKTA 458 ( DISEMAK 1991 )  
B. LAND SURVEYING ( HONS ) UTM, MRISM, MAALS

JURUKUR BANDARDESA SDN BHD ( 1325406-T )  
( Dahulunya Dikenali Sebagai JURUKUR BANDARDESA )  
NO. 17-3 JALAN USJ 9/50  
SUBANG BUSINESS CENTRE  
47620 SUBANG JAYA  
SELANGOR DARUL EHSAN  
TEL : 03-80230963 , 80230968  
FAX : 03-80230962  
email : bandaradesa@yahoo.com , bandaradesa@gmail.com

PLAN NO. : JBD / SEL / 585 / T / TP / 31521-31526 / P1



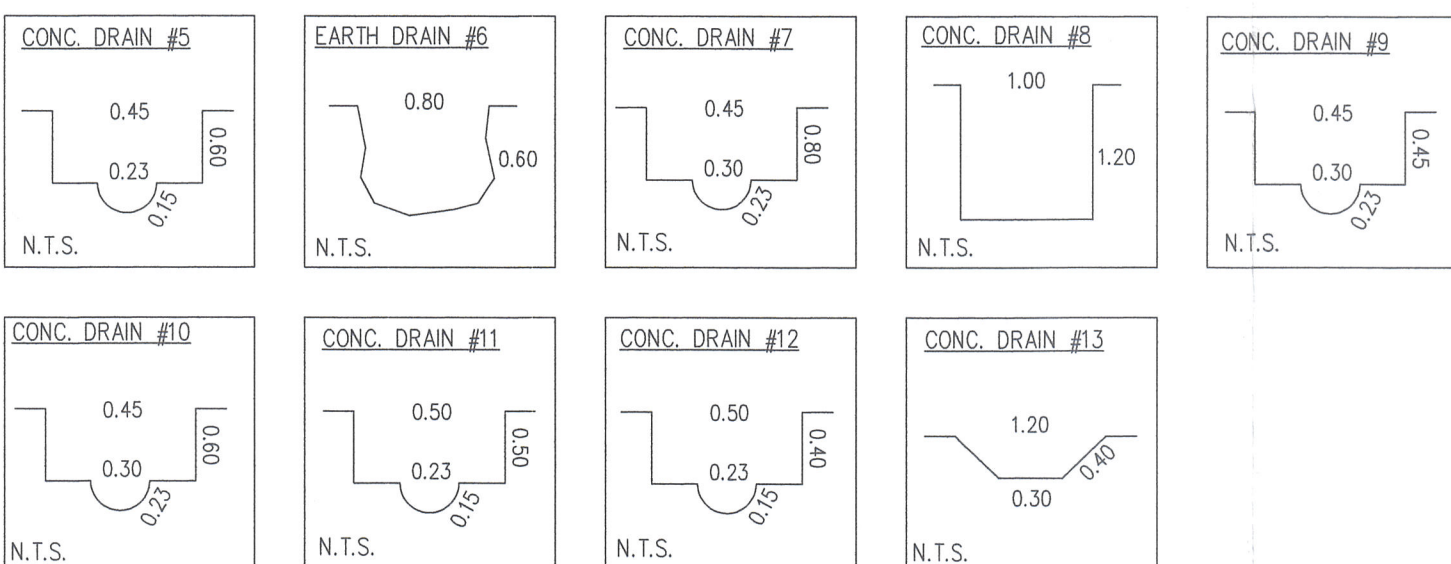
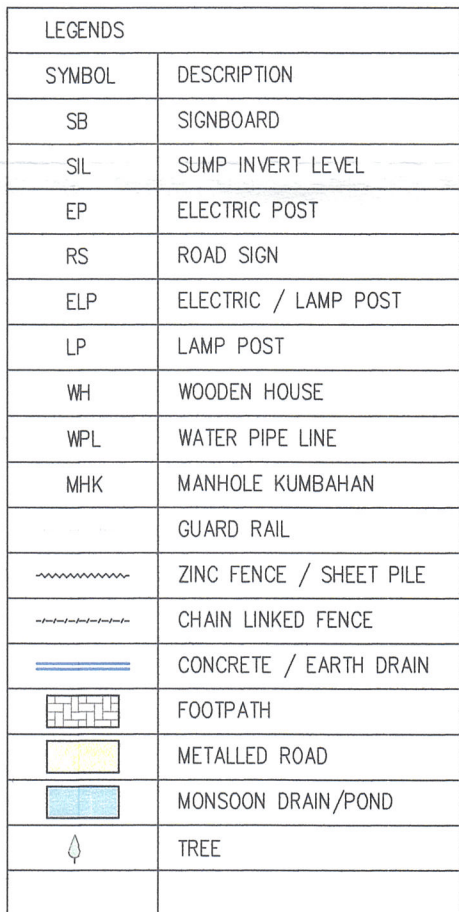

DETAIL AND SPOT LEVEL SURVEY ON  
LOT 31521, 31522, 31523, 31524 & 31526  
MUKIM KAPAR, DAERAH KLANG  
SELANGOR DARUL EHSAN

1. ALL MEASUREMENT ARE IN METRES.
3. SEMUA ARAS LARAS ADALAH BERDASARKAN BM B0847 (RL : 3.180m) DI KANAN JALAN KAPAR-KLANG. DI HADAPAN STESEN MINYAK PETRONAS. DI KAWASAN TAMAN BUNGA

SURVEYED BY : F00 12-MAY-21

DRAWN BY : TEO 20-MAY-21

Sr LOH SOW KAM  
URUKUR TANAH BERLESEN  
MAM. MATA. 100 (BASTIAN 1999)

 NO. 17-3 JALAN USJ 9/5Q  
SUBANG BUSINESS CENTRE  
47620 SUBANG JAYA  
SELANGOR DARUL EHSAN  
TEL : 03-80230963 , 80230968  
FAX : 03-80230962  
email : bandardesa@yahoo.com , bandardesa@gmail.com

PLAN NO. : JBD / SEL / 585 / T / TP / 31521-31526 / P2